

# QYM-Double Wire Fence

QYM-Double Wire Fence is a flat panel, constructed from double horizontal wires and a vertical wire which can create a strong rigid fence when fitted to a RHS post or SHS post.

## Panel-(6/5/6 - 8/6/8)

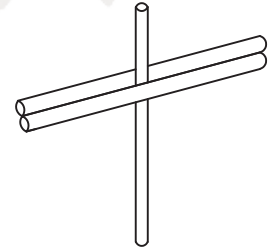
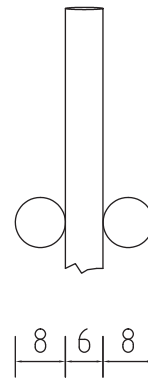
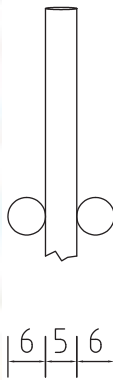

### Size A-(6/5/6)

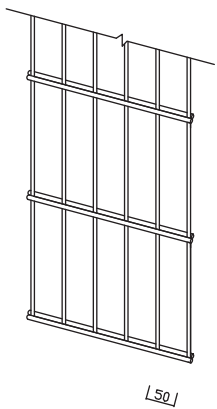

Product Name	Mesh Size	Wire Thickness	Coating	Panel Width	Panel Height	Panel Weight
Double Panel	50x200mm 55x200mm	1xø5mm Vertical wire & 2xø6mm Horizontal wire	Galvanised and Electrostatic polyester powder coated	2, 50 m	0, 63 m	9, 00 Kg
					0, 83 m	11, 50 Kg
					1, 03 m	14, 20 Kg
					1, 23 m	16, 80 Kg
					1, 43 m	19, 30 Kg
					1, 63 m	21, 90 Kg
					1, 83 m	24, 60 Kg
					2, 03 m	27, 10 Kg
					2, 23 m	29, 20 Kg
2, 43 m	31, 70 Kg					

### Size B-(8/6/8)

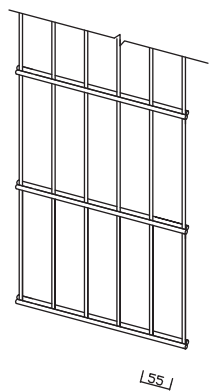

Product Name	Mesh Size	Wire Thickness	Coating	Panel Width	Panel Height	Panel Weight
Double Panel	50x200mm 55x200mm	1xø6mm Vertical wire &2xø8mm Horizontal wire	Galvanised and Electrostatic polyester powder coated	2, 50 m	0, 63m	14, 60 kg
					0, 83m	18, 80 kg
					1, 03m	23, 00 kg
					1, 23m	27, 10 kg
					1, 43m	31, 30 kg
					1, 63m	35, 40 kg
					1, 83m	39, 50 kg
					2, 03m	43, 70 kg
					2, 23m	48, 00 kg
					2, 43m	52, 00 kg



10 YEAR WARRANTY

# QYM-Double Wire Fence

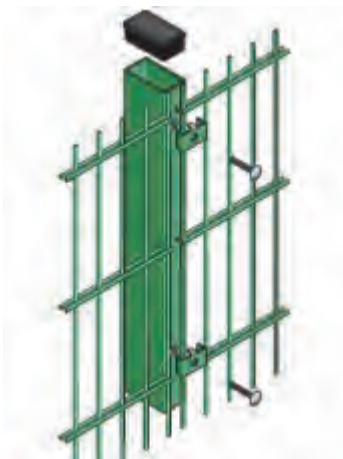

## Post-Type A (RHS Pipe)

Profile	Wall Thickness	Surface Treatment	Length	Base Plate	Rain hat
60x40mm	2.0mm	Galvanized and Electrostatic polyester powder coated	On the basis of panel height	Available	Plastic or metal
80x40mm	2.5mm				

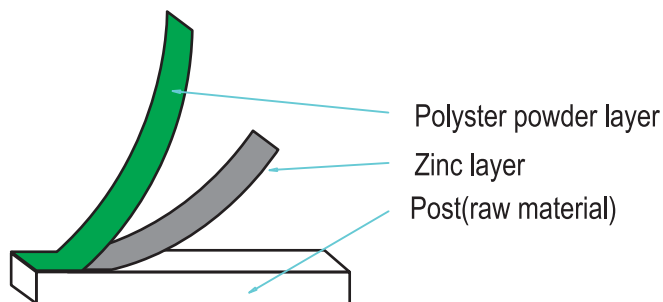

## Post-Type B (SHS Pipe)

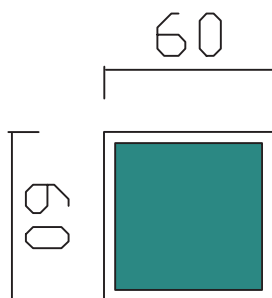

Profile	Wall Thickness	Surface Treatment	Length	Base Plate	Rain hat
60x60mm	1.50mm - 4.00mm	Galvanized and Electrostatic polyester powder coated	On the basis of panel height	Available	Plastic or metal



### Variations for post:

The posts are available in a range of lengths to accommodate panel heights and ground conditions. In addition, many variations are available:

- wall fixing plates, cranked posts or base plated
- cranked or straight extensions for barbed or razor wire
- cranked panels

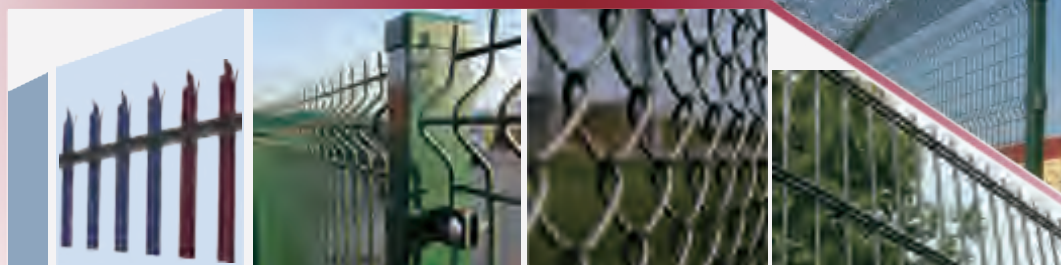

# QYM-Double Wire Fence



## Fittings...

For Post Type A, M8x40 safety bolt and 47x25mm steel clips are required;  
For Post Type B, similar as type A.

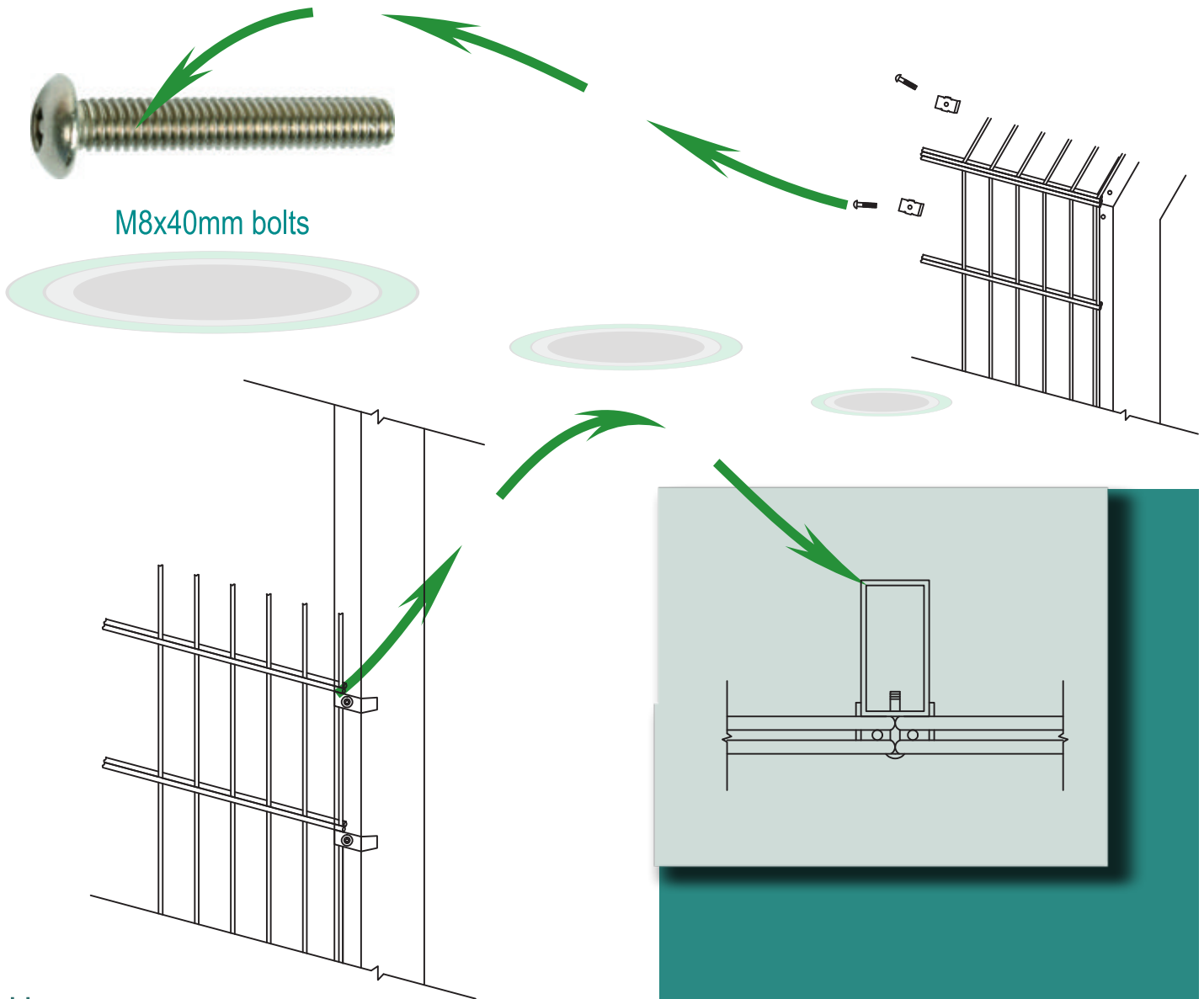

M8x40mm bolts

47x25mm metal clips

## Use

- \* Government place
- \* Factory land
- \* School playgrounds
- \* Public buildings
- \* Car parks
- \* Business parks and retail premises
- \* Other places

10 YEAR WARRANTY

